

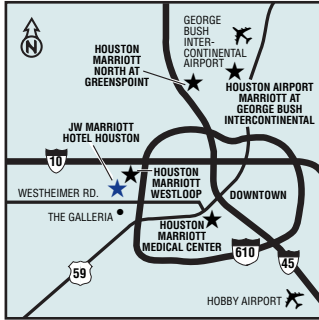

**JW MARRIOTT
HOUSTON**

5150 Westheimer Road HOJJW
Houston, Texas 77056
(713) 961-1500
Guest FAX: (713) 961-5045
Sales FAX: (713) 599-2102
mhhs.houjw.dom@Marriott.com
Marriott.com/HOUJW



DIRECTIONS

From Houston Intercontinental Airport: 27 miles. Take JFK Blvd. to Beltway 8 West to 45 South to 610 West/South. Exit Westheimer, turn right. Hotel entrance is past the 2nd stoplight/McCue St. on the right before Sage Rd.
From Hobby Airport: 16 miles. Take Airport Blvd. to I-45 North to 610 West/North. Exit Westheimer, turn left. Hotel entrance is past the 2nd stoplight/McCue St. on the right before Sage Rd.

GUEST ROOM INFORMATION

Floors: 23 Dbl/dbl: 187
Rooms: 514 Kings: 327
Accessible: 14 Max in room: 4
No-Smoke: 498 Check-in: 3:00 p.m.
Suites: 24 Checkout: Noon
Parlors: 2 Tariff Plan: European

The majestic 23-story building houses 514 newly renovated (completed March 31, 2005) guest rooms including 26 suites. All rooms have individual climate controls, three telephones with voice mail and data port, AM/FM alarm clock radio, iron and ironing board, coffee maker, complimentary coffee and tea, hair dryer, remote-controlled 25" flat-screen TV, digital On-Command Video movies, STSN high-speed Internet access and residential touches in the rooms, such as window seats, warm colors, and throw pillows to name a few. The hotel offers a Concierge Lounge and seven Concierge floors.

GUEST SERVICES AND SHOPS

- Safe-deposit boxes
- Concierge
- Business center
- Valet service
- Free parking available
- Notary public
- Gift shop
- ATM
- Garage self-parking and valet parking for a charge, free surface parking
- Soda, ice & vending machines

RECREATIONAL FACILITIES

- Exercise facility
- Whirlpool
- Racquetball courts (2)
- Massage
- Basketball court
- Steam room
- Indoor/outdoor pool
- Sauna

PLACES TO SEE/THINGS TO DO

- The Galleria Shopping Mall
- Houston Astros at Minute Maid Park
- Houston Comets at Toyota Center
- Houston Rockets at Toyota Center
- Houston Texans at Reliant Stadium

RESTAURANTS AND LOUNGES

Name	Seats/Capacity	Meals Served
Brasserie Restaurant	166	B,L,D
Lobby Lounge	88	

- Houston Livestock Show and Rodeo
- The Museum & Arts District
- Lakewood Church
- Houston Zoo & Hermann Park
- Space Center Houston - NASA
- San Jacinto Monument and Museum
- Battleship Texas State Historic Site
- Galveston Island Beach

GENERAL INFORMATION

- Credit Cards Accepted: American Express, MasterCard, Diners Club, VISA, Discover Card.
- Hotel Tax: 17%
- Reservations: Must be guaranteed by one night's deposit, company guarantee or credit card.
- Special Plans: Airline, government, military and travel industry discounts.

MEETING AND BANQUET FACILITIES

- 40,000 total square feet of flexible meeting space.

Meeting Room	DIMENSIONS			CAPACITY					# OF TABLES	
	WxLxH		Sq. Ft. (Metric)	Theater	School-room	Conference	U-Shape	Reception	Rounds/ 10	Rounds/ 12
	U.S.	Metric								
Grand Ballroom	107x95x18	32.7x29x5.5	10,000 (948.3)	900	500	-	-	900	72	-
Pre-function	107x17x10	32.7x5.2x3	1,819 (169)	-	-	-	-	200	-	-
Salon A	33x78x18	10.1x23.8x5.5	2,574 (240.4)	250	150	60	50	250	21	-
Salon B	41x78x18	12.5x23.8x5.5	3,198 (297.5)	420	220	65	60	350	28	-
Salon C	33x78x18	10.1x23.8x5.5	2,574 (240.4)	250	130	50	50	250	18	-
Salon A/B or B/C	74x78x18	22.6x23.8x5.5	5,772 (537.9)	720	420	-	-	650	47	-
Harris	26x37x13	8x11.3x4	962 (89.5)	70	30	28	24	50	5	-
Hidalgo	34x37x13	10.4x11.3x4	1,258 (117)	100	60	32	30	100	8	-
Navarro	24x37x13	7.4x11.3x4	888 (82.6)	70	30	28	24	50	4	-
Harris/Hidalgo	60x37x13	18.3x11.3x4	2,220 (206.8)	170	90	48	50	150	12	-
Hidalgo/Navarro	58x37x13	17.7x11.3x4	2,146 (200)	170	90	48	50	150	12	-
Harris/Hidalgo/Navarro	84x37x13	25.7x11.3x4	3,108 (288.9)	240	160	50	50	250	20	-
Baxer	21x28x13	6.4x8.6x4	588 (54.7)	50	20	20	18	40	3	-
Travis	24x28x14	7.4x8.6x4.3	672 (62.6)	60	30	24	20	50	4	-
Nueces	21x28x15	6.4x8.6x4.6	588 (54.7)	50	20	20	18	40	3	-
Baxer/Travis	45x28x13	13.7x8.6x4	1,260 (117.8)	110	50	36	38	90	7	-
Travis/Nueces	45x28x13	13.7x8.6x4	1,260 (117.8)	110	50	36	38	90	7	-
Bexar/Travis/Nueces	66x28x13	20.2x8.6x4	1,848 (171.9)	160	80	50	50	130	12	-
Sam Houston	21x63x13	6.4x19.3x4	1,323 (123)	120	70	30	30	100	8	-
Lamar	-	-	2,480 (230.7)	-	-	28	24	150	12	-
Austin (Upper)	24x46x9	7.4x14x2.7	1,058 (103.6)	30	-	20	-	80	7	-
Austin (Lower)	28x46x12	8.6x14x3.7	1,288 (120.4)	60	48	28	24	90	8	-
Austin	-	-	2,346 (223.4)	-	-	-	-	170	15	-
Dallas	28x39x9	8.6x11.9x2.7	1,092 (102.3)	70	44	30	26	75	5	-
Galveston	28x42x9	8.6x12.8x2.7	1,176 (110.1)	70	44	30	26	75	5	-
Boardroom (pre-set Conference)	13x24x9	4x7.4x2.7	312 (29.6)	20	16	18	-	-	1	-
San Antonio	17x26x9	5.2x7.9x2.7	442 (41.1)	20	16	18	-	-	1	-
Exhibit Hall	115x118x23	35.1x36x7	13,570 (1,263.6)	1,150	700	-	-	1,950	110	-
Salon I	59x118x23	18x36x7	6,962 (648)	575	350	-	-	950	45	-
Salon II	56x118x23	17.1x36x7	6,608 (614.6)	575	350	-	-	950	45	-
Exhibit Hall Foyer	62x66x11	18.9x20.1x3.4	3,430 (379.9)	200	100	-	-	400	-	-

**LOBBY (STREET) LEVEL
FIRST FLOOR**

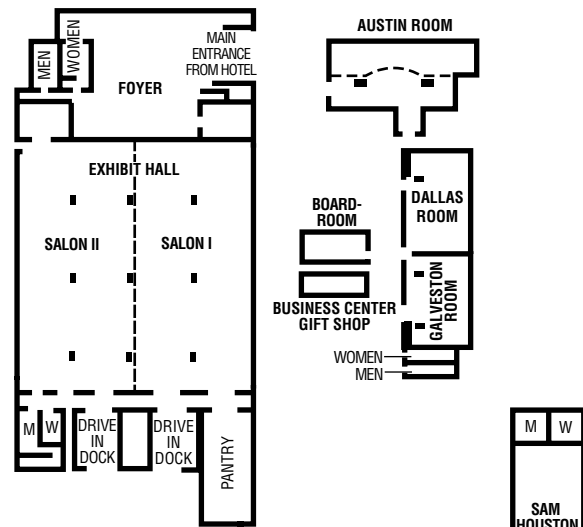

**MEZZANINE LEVEL
(SECOND FLOOR)**

